

**HOGGER
DT10**

HSH High System Hoggers

Characteristics:

High quality finishing cut at medium and high speed

Recommended for a maximum of 5 mm material removal

Recommended to process covered chipboard panels with melamine, laminate, veneered panels

RPM: 6.000

Feed rate:

from 20 to 80 mt/min

Assembly possible on all the alignment drums

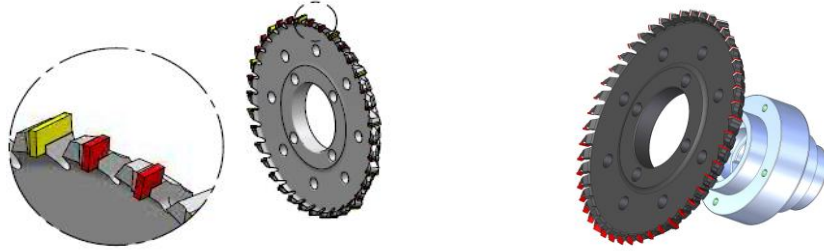

Wirutex Code	Biesse Code	Description
H00131		HSH HOGGER D.230X10X80+8+4 Z=36+6 RH
H00132		HSH HOGGER D.230X10X80+8+4 Z=36+6 LH
H00015	N3401N0192	HSH HOGGER D.230X10X80+4+8 Z=47+6 RH
H00016	N3401N0193	HSH HOGGER D.230X10X80+4+8 Z=47+6 LH
H00017		HSH HOGGER D.230X10X80+4+8 Z=59+6 RH
H00018		HSH HOGGER D.230X10X80+4+8 Z=59+6 LH

**HOGGER
DT10**

High System Hoggers for material removal up to 7 mm

Characteristics:

High quality finishing cut at medium and high speed

Recommended for a maximum of 7 mm material removal

Recommended to process covered chipboard panels with melamine, laminate, veneered panels

RPM: 6.000

Feed rate:

from 20 to 80 mt/min

Assembly possible on all the alignment drums

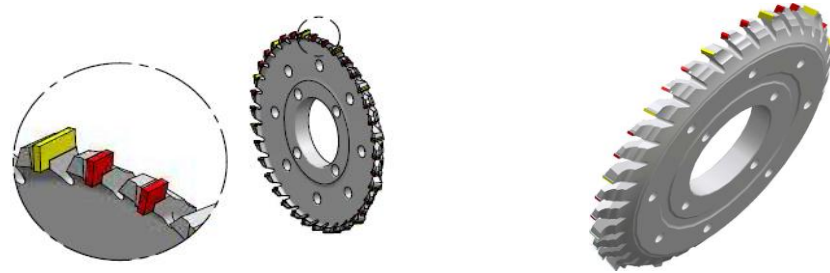

Wirutex Code	Biesse Code	Description
H00113		HSH HOGGER D.230X10 Z=36+12 RH
H00114		HSH HOGGER D.230X10 Z=36+12 LH
H00115		HSH HOGGER D.230X10 Z=47+12 RH
H00116		HSH HOGGER D.230X10 Z=47+12 LH
H00117		HSH HOGGER D.230X10 Z=59+12 RH
H00118		HSH HOGGER D.230X10 Z=59+12 LH

**HOGGER
DT10**

High System Hoggers for material removal up to 10 mm

Characteristics:

High quality finishing cut at medium and high speed

Recommended for a maximum of 10 mm material removal

Recommended to process covered chipboard panels with melamine, laminate, veneered panels

RPM: 6.000

Feed rate:

from 20 to 80 mt/min

Assembly possible on all the alignment drums

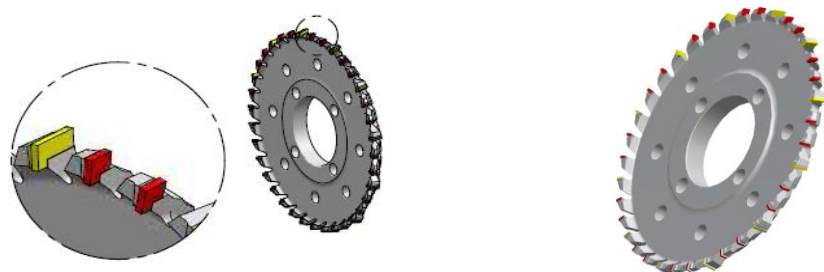

Wirutex Code	Biesse Code	Description
H00025		HSH HOGGER D.230X10 Z=36+18 RH
H00026		HSH HOGGER D.230X10 Z=36+18 LH
H00027		HSH HOGGER D.230X10 Z=47+16 RH
H00028		HSH HOGGER D.230X10 Z=47+16 LH
H00029		HSH HOGGER D.230X10 Z=59+30 RH
H00030		HSH HOGGER D.230X10 Z=59+30 LH

Hogger fixing support

HYDRO Alignment drum

Characteristics:

Blocking and alignment drum with HYDRO locking system
Extremely high alignment precision

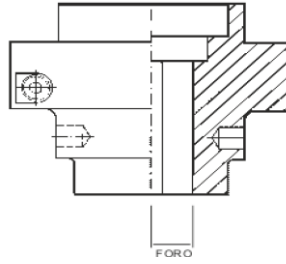

Wirutex Code	Biesse Code	Description
C01179		HYDRO-GRIP EI-40/80-90

Hogger fixing support

MECHANICAL Alignment drum

Characteristics:

Blocking and alignment drum with MECHANICAL locking system

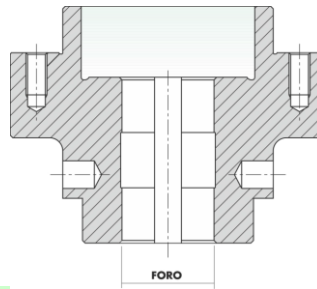

Wirutex Code	Biesse Code	Description
S03213	N3401N0588	DRUM D.120X63X40+2KW

Hogger fixing support

PNEUMATIC Alignment drum

Characteristics:

Blocking and alignment drum with MECHANICAL locking system and pneumatic fast tool release

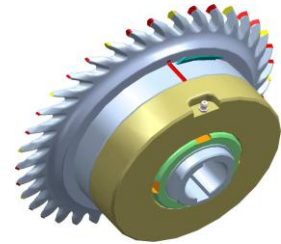
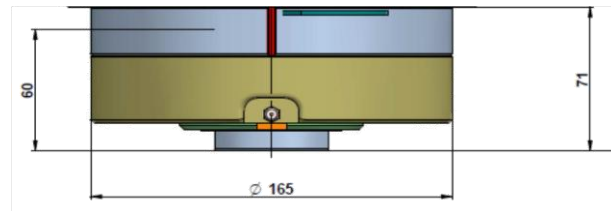

Wirutex Code	Biesse Code	Description
S11354		PNEUMATIC DRUM F.40+2KW H=58

**Grinding Unit
RT20-RT30**

Grinding cutter, LOW-NOISE "ECO"

Characteristics:

Finishing cutters for single shoulder edge banding machine

Design:

LOW-NOISE: significant noise reduction during the working process 30° OR 45° brazed-welded pushing tips with axial inclination for a high-quality finishing cut

RPM: 9.000/12.000

Materials: chipboard, melamine, honeycomb wood, veneered panels, MDF

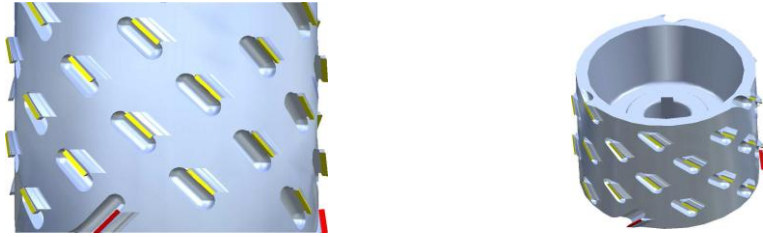

Wirutex Code	Biesse Code	Description
S13045	CSEN350069	PCD CUTTER D.125X44X30+2KW 45° Z=3+3 CW.
S13046	CSEN350068	PCD CUTTER D.125X44X30+2KW 45° Z=3+3 CCW.
S13047	CSEN350073	PCD CUTTER D.125X64X30+2KW 45° Z=3+3 CW.
S13048	CSEN350074	PCD CUTTER D.125X64X30+2KW 45° Z=3+3 CCW.
S05237	N3401N0316	PCD CUTTER D.125X97X30+2KW 45° Z=6+6 LH
S05236	N3401N0317	PCD CUTTER D.125X97X30+2KW 45° Z=6+6 RH
S12886	CSEN350048	PCD CUTTER D.125X44X30+2KW 30° Z=3+3 SYMM.
S13191	CSEN350087	PCD CUTTER D.125X64X30+2KW 30° Z=3+3 SYMM.
S12896	CSEN350049	PCD CUTTER D.125X44X30+2KW 45° Z=3+3 SYMM.

**Grinding Unit
RT20-RT30**

Grinding cutter, LOW NOISE "HIGH PERFORMANCE"

Characteristics:

Finishing cutters for single shoulder edge banding machine

Design:

LOW-NOISE: significant noise reduction during the working process. Pushing tips with axial inclination for a high-quality finishing cut

RPM: 9.000/12.000

Materials: chipboard, melamine, honeycomb wood, veneered panels, MDF

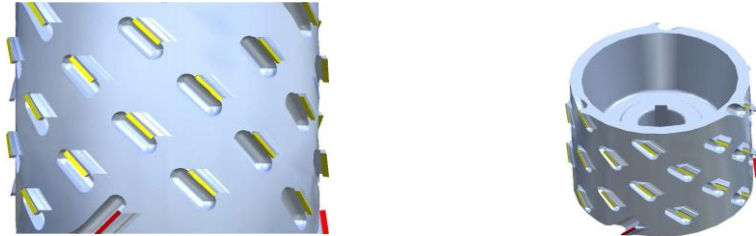

Wirutex Code	Biesse Code	Description
S14343		PCD CUTTER D.125X34X30+2KW 45° Z=3+3 RH
S14344		PCD CUTTER D.125X34X30+2KW 45° Z=3+3 LH
S14086	CSEN350137	PCD CUTTER D.125X47X30+2KW 45° Z=3+3 RH
S14087	CSEN350138	PCD CUTTER D.125X47X30+2KW 45° Z=3+3 LH
S14324	CSEN350139	PCD CUTTER D.125X67X30+2KW 45° Z=3+3 RH
S14325	CSEN350140	PCD CUTTER D.125X67X30+2KW 45° Z=3+3 LH

**Grinding Unit
RT20-RT30**

Grinding cutter STREAM MDS, "HIGH PERFORMANCE"

Characteristics:

Finishing cutters.

Design:

RPM: 9.000/12.000

Materials: chipboard, melamine, honeycomb wood, veneered panels, MDF

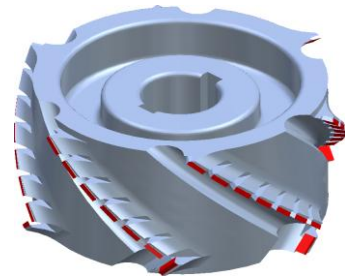

Wirutex Code	Biesse Code	Description
S14347		PCD CUTTER D.125X33X30+2KW 45° Z=3+3 RH
S14348		PCD CUTTER D.125X33X30+2KW 45° Z=3+3 LH
S14345		PCD CUTTER D.125X47X30+2KW 45° Z=3+3 RH
S14346		PCD CUTTER D.125X47X30+2KW 45° Z=3+3 LH
S12216	3401A0457	PCD CUTTER D.125x63x30+2KW 45° Z=3+3 RH
S12217	3401A0458	PCD CUTTER D.125x63x30+2KW 45° Z=3+3 LH

Grinding Unit
EXTERNAL MOTOR

Grinding cutter STREAM MDS, LOW NOISE "HIGH PERFORMANCE"

Characteristics:

Finishing cutters for single shoulder edge banding machine

Design:

LOW-NOISE: significant noise reduction during the working process. Pushing tips with axial inclination for a high-quality finishing cut

RPM: 9.000/12.000

Materials: chipboard, melamine, honeycomb wood, veneered panels, MDF

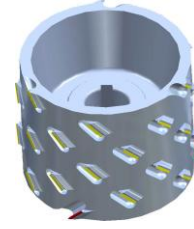
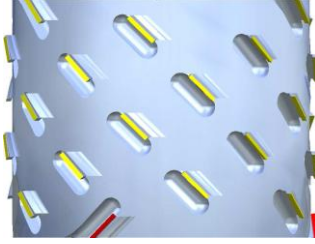

Wirutex Code	Biesse Code	Description
S14343		PCD CUTTER D.125X34X30+2KW 45° Z=3+3 RH
S14344		PCD CUTTER D.125X34X30+2KW 45° Z=3+3 LH
S14086	CSEN350137	PCD CUTTER D.125X47X30+2KW 45° Z=3+3 RH
S14087	CSEN350138	PCD CUTTER D.125X47X30+2KW 45° Z=3+3 LH
S14324	CSEN350139	PCD CUTTER D.125X67X30+2KW 45° Z=3+3 RH
S14325	CSEN350140	PCD CUTTER D.125X67X30+2KW 45° Z=3+3 LH

Grinding Unit
EXTERNAL MOTOR

Grinding cutter STREAM MDS, "HIGH PERFORMANCE"

Characteristics:

Finishing cutters.

Design:

RPM: 9.000/12.000

Materials: chipboard, melamine, honeycomb wood, veneered panels, MDF

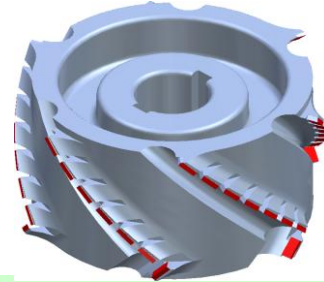

Wirutex Code	Biesse Code	Description
S14347		PCD CUTTER D.125X33X30+2KW 45° Z=3+3 RH
S14348		PCD CUTTER D.125X33X30+2KW 45° Z=3+3 LH
S14345		PCD CUTTER D.125X47X30+2KW 45° Z=3+3 RH
S14346		PCD CUTTER D.125X47X30+2KW 45° Z=3+3 LH
S12216	3401A0457	PCD CUTTER D.125x63x30+2KW 45° Z=3+3 RH
S12217	3401A0458	PCD CUTTER D.125x63x30+2KW 45° Z=3+3 LH

End cutting unit
IT90 - S / M / X

End cutting unit with inclined tooth

Characteristics:

End cutting of glued edges

Design:

30° inclined tooth

RPM:

12.000

Materials:

Solid wood edges, supported edges, plastic edges



Wirutex Code	Biesse Code	Description
C02930	N3401N0302	HM SAW BLADE D.130X3,6X30+4 Z=20+4 30° RH
C02931	N3401N0303	HM SAW BLADE D.130X3,6X30+4 Z=20+4 30° LH

End cutting unit
IT90

End cutting unit with alternate negative tooth for SOFT

Characteristics:

End cutting of glued edges

Design:

Negative alternate tooth - 20°

RPM:

12.000

Materials:

Plastics

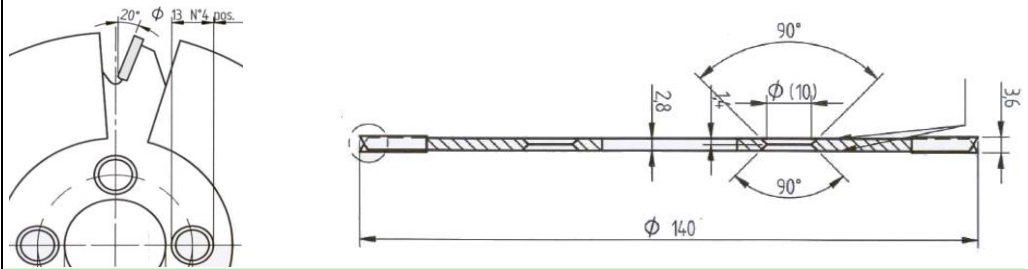

Wirutex Code	Biesse Code	Description
D02305	N3401N0464	HM SAW BLADE D.140X3,6X30+4 Z=20+4 -20° ALT. TOOTH

End cutting unit
IT90

End cutting unit with alternate tooth for solid wood

Characteristics:

End cutting of glued edges

Design:

Alternate tooth

RPM:

12.000

Materials:

Wood

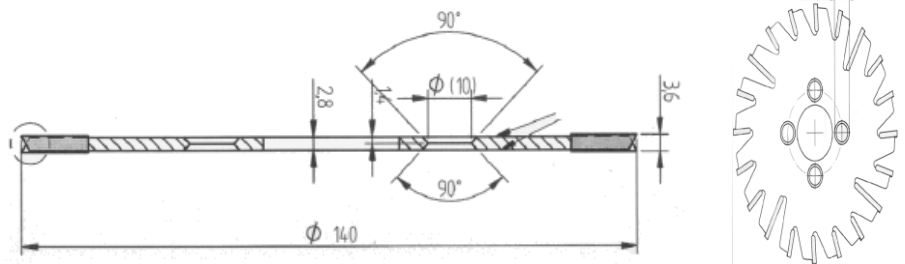

Wirutex Code	Biesse Code	Description
C03005	N3401N0301	HM SAW BLADE D.130X3,6X30+4 Z=16+4 ALT. TOOTH

End cutting unit
IT90

End cutting unit with alternate tooth for H90 solid wood

Characteristics:

End cutting of glued edges

Design:

Alternate tooth

RPM:

12.000

Materials:

H.90 wood

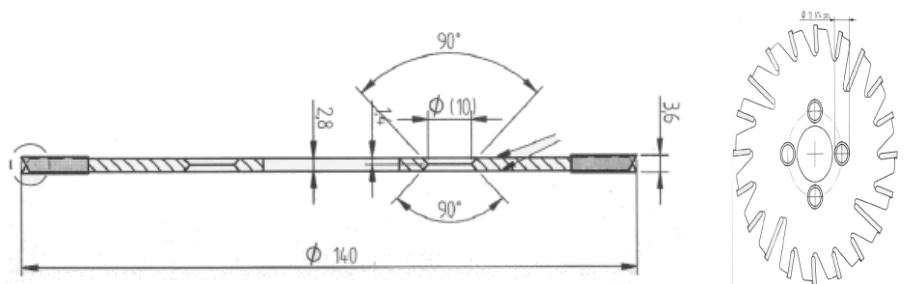

Wirutex Code	Biesse Code	Description
C03257	N3401N0336	HM SAW BLADE D.140X3,6X30+4 Z=16+4 ALT. TOOTH

**Trimmer Unit
RS10**

Overlapped trimmers with interchangeable HM knives

Characteristics:
For edge trimming

Design:
With interchangeable HM knives

RPM:
18.000

Materials:
Solid wood edges, supported edges, plastic edges

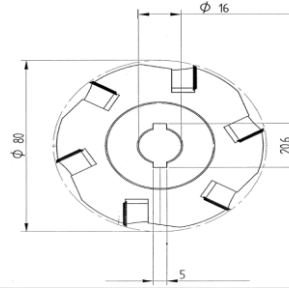

Wirutex Code	Biesse Code	Description
D02125	N3401N0428	HM CUTTER WITH KNIVES.D.80X25X16+2KW Z=6
D02135	N3402N0127	HM KNIFE 25X12X1.5

**Fine trimming unit
RF 10**

Trimmer for tilted engines with HM interchangeable knives

Characteristics:
For edge trimming on tilted engines

Design:
With interchangeable HM knives for chamfers and radiuses R1 - R1,5 - R2 - R3
1 Radius each cutter

RPM:
18.000

Materials:
Solid wood edges, supported edges, plastic edges

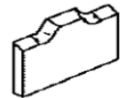
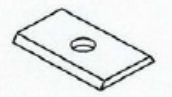
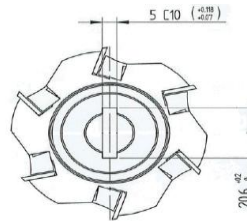
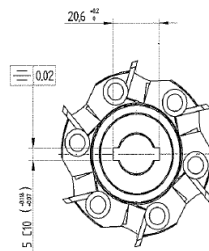

Wirutex Code	Biesse Code	Description
D02126	N3401N0430	HM CUTTER WITH KNIVES D.70X20X16+2KW Z=6
C00403	N3402N0040	HM KNIFE 20X12X1,5
D02368	N3401N0431	HM CUTTER WITH KNIVES D.70X20X16+2KW R=1 Z=6
D02372	N3402N0123	HM KNIFE R=1
D02369	N3401N0432	HM CUTTER WITH KNIVES D.70X20X16+2KW R=1,5 Z=6
D02373	N3402N0124	HM KNIFE R=1,5
D02370	N3401N0433	HM CUTTER WITH KNIVES D.70X20X16+2KW R=2 Z=6
D02374	N3402N0125	HM KNIFE R=2
D02127	N3401N0434	HM CUTTER WITH KNIVES D.70X20X16+2KW R=3 Z=6
D02134	N3402N0126	HM BRAZED-WELDED CUTTER D.60X9X16+2KW 25° Z=6 CW.

**Fine trimming unit
RF 10**

Fine trimming cutter with brazed-welded PCD tips

Characteristics:
For edge fine trimming

Design:
Cutters with straight PCD tips, brazed-welded by induction machine with optical/electronic control

RPM: 12.000/15.000

Materials:
Solid wood edges, supported edges, plastic edges



Wirutex Code	Biesse Code	Description
S08913	N3401N0435	PCD CUTTER D.70X20X16+2KW Z=6
S09643	N3401N0581	PCD CUTTER D.70X8X16+2KW Z=6

Fine trimming unit
RF 10

Rounding cutter with brazed-welded PCD tips

Characteristics:
For edge spoking

Design:
Cutters with PCD profiled tips, brazed-welded by induction machine with optical/electronic control
Radius 1 - 1,5 -2 - 3

RPM: 12.000/15.000

Materials:
Solid wood edges, supported edges, plastic edges



Wirutex Code	Biesse Code	Description
S12350	N3401N0377	PCD CUTTER D.70X20X16+2KW R=1 Z=6 CW.
S12351	N3401N0378	PCD CUTTER D.70X20X16+2KW R=1 Z=6 CCW.
S13052	N3401N0379	PCD CUTTER D.70X20X16+2KW R=1,5 Z=6 CW.
S13053	N3401N0380	PCD CUTTER D.70X20X16+2KW R=1,5 Z=6 CCW.
S13054	N3401N0381	PCD CUTTER D.70X20X16+2KW R=2 Z=6 CW.
S13055	N3401N0382	PCD CUTTER D.70X20X16+2KW R=2 Z=6 CCW.
S13056	N3401N0383	PCD CUTTER D.70X20X16+2KW R=3 Z=6 CW.
S13057	N3401N0384	PCD CUTTER D.70X20X16+2KW R=3 Z=6 CCW.

Fine trimming unit
RF 12

Fine trimming cutter with with brazed-welded PCD tips

Characteristics:
For edge fine trimming

Design:
Cutters with PCD inclined tips, brazed-welded by induction machine with optical/electronic control

RPM: 12.000/15.000

Materials:
Solid wood edges, supported edges, plastic edges

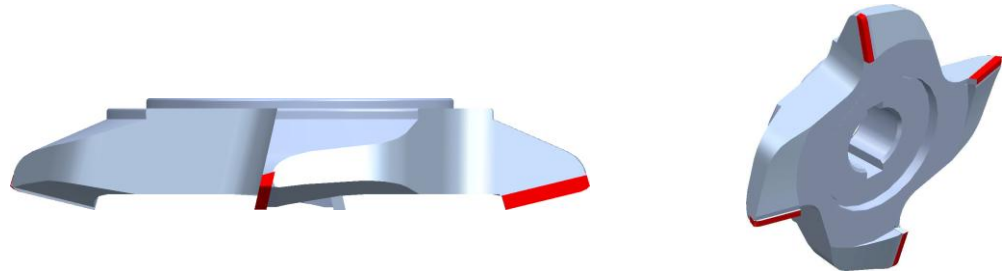

Wirutex Code	Biesse Code	Description
S08782	N3401N0436	PCD CUTTER D.80X10X16+2KW 15° Z=4 CW.
S08783	N3401N0437	PCD CUTTER D.80X10X16+2KW 15° Z=4 CCW.

**Fine trimming unit
RF30 - RF40**

**Trimming/fine trimming cutter for tilting engines with HM multi-radius
interchangeable knives**

Characteristics:

For edge trimming on tilted engines

Design:

With interchangeable HM knives for chamfers and radiuses R1 - R1,5 - R2 - R3
3 Radiuses + chamfer each cutter

RPM:

18.000

Materials:

Solid wood edges, supported edges, plastic edges

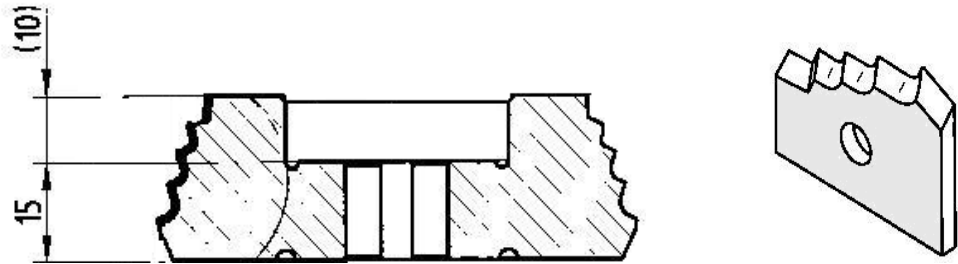

Wirutex Code	Biese Code	Description
D02128	N3401N0391	HM CUTTER WITH KNIVES D.75X25X16+2KW R=1,5/2/3/25° Z=4 CW.
D01540	N3402N0035	HM KNIFE 25X19,6X2 R=1,5/2/3
D02129	N3401N0392	HM CUTTER WITH KNIVES D.75X25X16+2KW R=1,5/2/3/25° Z=4 CCW.
D01541	N3402N0036	HM KNIFE 25X19,6X2 R=1,5/2/3
D02378	N3401N0393	HM CUTTER WITH KNIVES D.75X25X16+2KW R=1/2/3/25° Z=4 CW.
D01701	N3402N0085	HM KNIFE 25X19,6X2 R=1/2/3
D02379	N3401N0394	HM CUTTER WITH KNIVES D.75X25X16+2KW R=1/2/3/25° Z=4 CCW.
D01700	N3402N0084	HM KNIFE 25X19,6X2 R=1/2/3
D02380	N3401N0395	HM CUTTER WITH KNIVES D.75X25X16+2KW R=1/1,5/2/25° Z=4 CW.
D01999	N3402N0083	HM KNIFE 25X19,6X2 R=1/1,5/2
D02381	N3401N0396	HM CUTTER WITH KNIVES D.75X25X16+2KW R=1/1,5/2/25° Z=4 CCW.
D01998	N3402N0082	HM KNIFE 25X19,6X2 R=1/1,5/2

**Fine trimming unit
RF30 - RF40**

**Trimming/fine trimming cutter for tilting engines with PCD multi-radius
brazed-welded induction knives**

Characteristics:

For edge trimming on tilted engines

Design:

Cutters with PCD multi-radius tips, brazed-welded by induction machine with optical/electronic control
3 Radiuses + chamfer each cutter

RPM:

18.000

Materials:

Solid wood edges, supported edges, plastic edges

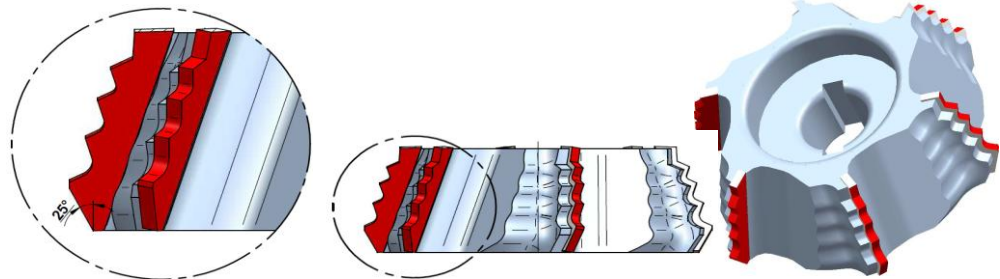

Wirutex Code	Biese Code	Description
S10540	N3401N0397	PCD CUTTER D.75.4X25X16+2KW Z=6 R=1/2/3/25° CW.
S10541	N3401N0398	PCD CUTTER D.75.4X25X16+2KW Z=6 R=1/2/3/25° CCW.
S09784	N3401N0399	PCD CUTTER D.75.4X25X16+2KW Z=6 R=1,5/2/3/25° CW.
S09785	N3401N0400	PCD CUTTER D.75.4X25X16+2KW Z=6 R=1,5/2/3/25° CCW.
S09760	N3401N0401	PCD CUTTER D.75.4X25X16+2KW Z=6 R=1/1,5/2/25° CW.
S09761	N3401N0402	PCD CUTTER D.75.4X25X16+2KW Z=6 R=1/1,5/2/25° CCW.

**Fine trimming unit
RF30 - RF40**

Trimming/fine trimming cutter for tilting engines with HM multi-radius interchangeable knives

Characteristics:
For edge trimming on tilted engines

Design:
With interchangeable HM knives for chamfers and radiuses R1 - R1,5 - R2 - R3
2 Radiuses each cutter

RPM:
18.000

Materials:
Solid wood edges, supported edges, plastic edges

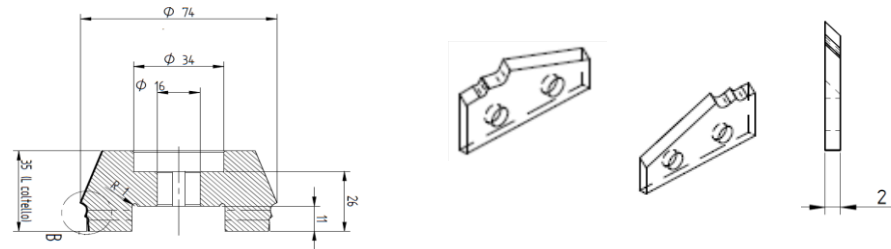

Wirutex Code	Biesse Code	Description
D02843	N3401N0564	HM CUTTER WITH KNIVES D.72X35X16+2KW R=1/1,5 Z=4 CW.
D02844	N3402N0159	HM KNIFE R=1/1,5
D02845	N3401N0565	HM CUTTER WITH KNIVES D.72X35X16+2KW R=1/1,5 Z=4 CCW.
D02846	N3402N0160	HM KNIFE R=1/1,5
D02847	N3401N0566	HM CUTTER WITH KNIVES D.72X35X16+2KW R=1/2 Z=4 CW.
D02848	N3402N0161	HM KNIFE R=1/2
D02849	N3401N0567	HM CUTTER WITH KNIVES D.72X35X16+2KW R=1/2 Z=4 CCW.
D02850	N3402N0162	HM KNIFE R=1/2
D02851	N3401N0568	HM CUTTER WITH KNIVES D.72X35X16+2KW R=1,5/2 Z=4 CW.
D02852	N3402N0163	HM KNIFE R=1,5/2
D02853	N3401N0569	HM CUTTER WITH KNIVES D.72X35X16+2KW R=1,5/2 Z=4 CCW.
D02854	N3402N0164	HM KNIFE R=1,5/2
D02855	N3401N0570	HM CUTTER WITH KNIVES D.72X35X16+2KW R=1,5/3 Z=4 CW.
D02856	N3402N0165	HM KNIFE R=1,5/3
D02857	N3401N0571	HM CUTTER WITH KNIVES D.72X35X16+2KW R=1,5/3 Z=4 CCW.
D02858	N3402N0166	HM KNIFE R=1,5/3
D02859	N3401N0572	HM CUTTER WITH KNIVES D.72X35X16+2KW R=2/3 Z=4 CW.
D02860	N3402N0167	HM KNIFE R=2/3
D02861	N3401N0573	HM CUTTER WITH KNIVES D.72X35X16+2KW R=2/3 Z=4 CCW.
D02862	N3402N0168	HM KNIFE R=2/3

**Rounding Unit
AR30 AR34**

Rounding cutter with HM interchangeable knives

Characteristics:
For edge spoking

Design:
With HM exchangeable knives for chamfers and radiuses R1 - R1,5 - R2 - R3
1 radius each cutter

RPM:
18.000

Materials:
Solid wood edges, supported edges, plastic edges

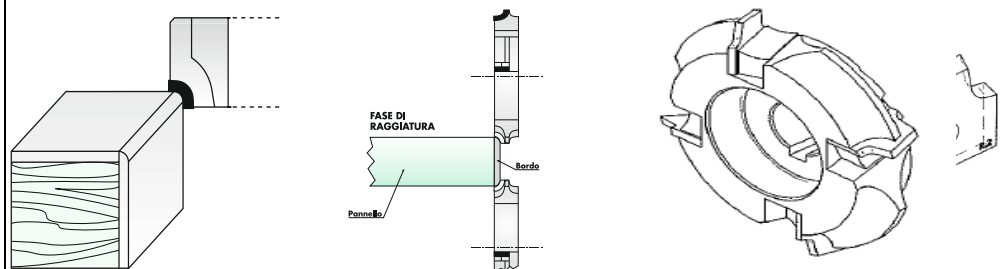

Wirutex Code	Biesse Code	Description
D03252	3401A0353	HM CUTTER WITH KNIVES D.70X20X16+2KW R=1.5 Z=4 20° CW.
D03253	3401A0354	HM CUTTER WITH KNIVES D.70X20X16+2KW R=1.5 Z=4 20° CCW.
D03254	3402A0086	HM KNIFE 16X16.5X2 R=1.5
D03255	3401A0355	HM CUTTER WITH KNIVES D.70X20X16+2KW R=1 Z=4 20° CW.
D03256	3401A0356	HM CUTTER WITH KNIVES D.70X20X16+2KW R=1 Z=4 20° CCW.
D03257	3402A0087	HM KNIFE 16X16.5X2 R=1
D03246	3401A0349	HM CUTTER WITH KNIVES D.70X20X16+2KW R=2 Z=4 20° CW.
D03247	3401A0350	HM CUTTER WITH KNIVES D.70X20X16+2KW R=2 Z=4 20° CCW.
D03248	3402A0084	HM KNIFE 16X16.5X2 R=2
D03249	3401A0351	HM CUTTER WITH KNIVES D.70X20X16+2KW R=3 Z=4 20° CW.
D03250	3401A0352	HM CUTTER WITH KNIVES D.70X20X16+2KW R=3 Z=4 20° CCW.
D03251	3402A0085	HM KNIFE 16X16.5X2 R=3

Rounding Unit
AR30 - AR34

Rounding cutter with HM brazed-welded tips

Characteristics:
For edge spoking

Design:
With HM brazed-welded tips for chamfers and radiuses R1 - R1,5 - R2 - R3
1 radius each cutter

RPM:
18.000

Materials:
Solid wood edges, supported edges, plastic edges



Wirutex Code	Biese Code	Description
D01578	N3401N0112	HM BRAZED-WELDED CUTTER D.60x9x16+2KW R=1 Z=6 CW.
D01579	N3401N0113	HM BRAZED-WELDED CUTTER D.60x9x16+2KW R=1 Z=6 CCW.
D01529	N3401N0107	HM BRAZED-WELDED CUTTER D.60x9x16+2KW R=1.5 Z=6 CW.
D01580	N3401N0108	HM BRAZED-WELDED CUTTER D.60x9x16+2KW R=1.5 Z=6 CCW.
D01482	N3401N0105	HM BRAZED-WELDED CUTTER D.60x9x16+2KW R=2 Z=6 CW.
D01483	N3401N0106	HM BRAZED-WELDED CUTTER D.60x9x16+2KW R=2 Z=6 CCW.
D01527	N3401N0103	HM BRAZED-WELDED CUTTER D.60x9x16+2KW R=3 Z=6 CW.
D01528	N3401N0104	HM BRAZED-WELDED CUTTER D.60x9x16+2KW R=3 Z=6 CCW.
D01522	N3401N0101	HM BRAZED-WELDED CUTTER D.60x9x16+2KW 25° Z=6 CW.
D01523	N3401N0102	HM BRAZED-WELDED CUTTER D.60x9x16+2KW 25° Z=6 CCW.
D01251	N3401N0161	HM BRAZED-WELDED CUTTER D.60x9x16+2KW 45° Z=6 CW.
D01252	N3401N0162	HM BRAZED-WELDED CUTTER D.60x9x16+2KW 45° Z=6 CCW.

Rounding Unit
AR30 - AR34

Fine trimming cutter with PCD brazed-welded tips

Characteristics:
For edge fine trimming

Design:
Cutters with straight PCD tips, brazed-welded by induction machine with optical/electronic control

RPM:
12.000/15.000

Materials:
Solid wood edges, supported edges, plastic edges



Wirutex Code	Biese Code	Description
S06800	N3401N0089	PCD CUTTER D.58,8X11X16+2KW 25° Z=6 CW.
S06801	N3401N0090	PCD CUTTER D.58,8X11X16+2KW 25° Z=6 CCW.

Rounding Unit
AR30 - AR34

Rounding cutter with PCD brazed-welded tips

Characteristics:
For edge spoking

Design:
Cutters with profiled PCD tips, brazed-welded by induction machine with optical/electronic control
Radius 1 - 1,5 -2 - 3

RPM: 12.000/15.000

Materials:
Solid wood edges, supported edges, plastic edges



Wirutex Code	Biese Code	Description
S14451	N3401N0110	PCD CUTTER D.60X11X16+2KW R=1 Z=6 CW.
S14450	N3401N0111	PCD CUTTER D.60X11X16+2KW R=1 Z=6 CCW.
S13811	N3401N0095	PCD CUTTER D.60X11X16+2KW R=1,5 Z=6 CW.
S13810	N3401N0096	PCD CUTTER D.60X11X16+2KW R=1,5 Z=6 CCW.
S14234	N3401N0093	PCD CUTTER D.60X11X16+2KW R=2 Z=6 CW.
S14233	N3401N0094	PCD CUTTER D.60X11X16+2KW R=2 Z=6 CCW.
S14453	N3401N0091	PCD CUTTER D.60X11X16+2KW R=3 Z=6 CW.
S14452	N3401N0092	PCD CUTTER D.60X11X16+2KW R=3 Z=6 CCW.

**Rounding Unit
AR30/AR34**

Q-SYSTEM®

Characteristics:

On demand flexible multi-radius system, specifically designed for the rounding multifunction unit of the whole range of Biesse Stream edgebanding machines.
For edge profiling.

Design:

Polycrystalline diamond tips.
2 radius available on demand.
Automatic change of radius.

THE MACHINE MUST BE PROVIDED OF SPECIFIC ROUNDING UNIT SUITABLE FOR MOUNTING Q-SYSTEM.



Wirutex Code	Biesse Code	Description
S13435	AS50100007	PCD CUTTER D.74X20X16+2KW R=1/2 Z=4+4 CW.
S13436	AS50100008	PCD CUTTER D.74X20X16+2KW R=1/2 Z=4+4 CCW.

**Rounding Unit
AR80**

Rounding cutter with HM brazed-welded tips

Characteristics:

For edge spoking

Design:

Cutters with profiled PCD tips, brazed-welded by induction machine with optical/electronic control
Radius 1 - 1,5 -2 - 3

RPM: 12.000/15.000

Materials:

Solid wood edges, supported edges, plastic edges



Wirutex Code	Biesse Code	Description
D01474	N3401N0232	HM BRAZED-WELDED CUTTER D.60X9X20+2KW R=3 Z=6 CW.
D01475	N3401N0233	HM BRAZED-WELDED CUTTER D.60X9X20+2KW R=3 Z=6 CCW.
D01530	N3401N0280	HM BRAZED-WELDED CUTTER D.60X9X20+2KW R=2 Z=6 CW.
D01531	N3401N0281	HM BRAZED-WELDED CUTTER D.60X9X20+2KW R=2 Z=6 CCW.
D01476	N3401N0282	HM BRAZED-WELDED CUTTER D.60X9X20+2KW R=1.5 Z=6 CW.
D01477	N3401N0283	HM BRAZED-WELDED CUTTER D.60X9X20+2KW R=1.5 Z=6 CCW.
D01532	N3401N0284	HM BRAZED-WELDED CUTTER D.60X9X20+2KW R=1 Z=6 CW.
D01533	N3401N0285	HM BRAZED-WELDED CUTTER D.60X9X20+2KW R=1 Z=6 CCW.
D01478	N3401N0286	HM BRAZED-WELDED CUTTER D.60X9X20+2KW 25° Z=6 CW.
D01479	N3401N0287	HM BRAZED-WELDED CUTTER D.60X9X20+2KW 25° Z=6 CCW.
D01967	N3401N0319	HM BRAZED-WELDED CUTTER D.60X9X20+2KW 45° Z=6 CW.
D01968	N3401N0320	HM BRAZED-WELDED CUTTER D.60X9X20+2KW 45° Z=6 CCW.

**Rounding Unit
AR80**

Rounding cutter with PCD brazed-welded tips

Characteristics:
For edge spoking

Design:
Cutters with profiled PCD tips,
brazed-welded by induction
machine with optical/electronic
control
Radius 1 - 1,5 -2 - 3

RPM: 12.000/15.000

Materials:
Solid wood edges, supported
edges, plastic edges

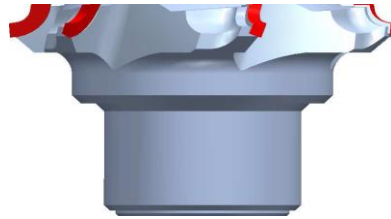

Wirutex Code	Biesse Code	Description
S13873	N3401N0288	PCD CUTTER D.60X9X20+2KW R=3 Z=6 CW.
S13872	N3401N0289	PCD CUTTER D.60X9X20+2KW R=3 Z=6 CCW.
S13875	N3401N0290	PCD CUTTER D.60X9X20+2KW R=2 Z=6 CW.
S13874	N3401N0291	PCD CUTTER D.60X9X20+2KW R=2 Z=6 CCW.
S14242	N3401N0292	PCD CUTTER D.60X9X20+2KW R=1.5 Z=6 CW.
S14244	N3401N0293	PCD CUTTER D.60X9X20+2KW R=1.5 Z=6 CCW.
S14104	N3401N0294	PCD CUTTER D.60X9X20+2KW R=1 Z=6 CW.
S14103	N3401N0295	PCD CUTTER D.60X9X20+2KW R=1 Z=6 CCW.
S13877	N3401N0296	PCD CUTTER D.60X9X20+2KW 25° Z=6 CW.
S13876	N3401N0297	PCD CUTTER D.60X9X20+2KW 25° Z=6 CCW.
S14455	N3401N0321	PCD CUTTER D.60X9X20+2KW 45° Z=6 CW.
S14454	N3401N0322	PCD CUTTER D.60X9X20+2KW 45° Z=6 CCW.

**Rounding Unit
AR80**

Q-SYSTEM®

Characteristics:
On demand flexible multi-radius
system, specifically designed for the
rounding multifunction unit of the whole
range of Biesse Stream edgebanding
machines.
For edge profiling.

Design:
Polycrystalline diamond tips.
3 radius available on demand.
Automatic change of radius.

RPM:

Feed rate:
**THE MACHINE MUST BE PROVIDED
OF SPECIFIC ROUNDING UNIT
SUITABLE
FOR MOUNTING Q-SYSTEM.**



Wirutex Code	Biesse Code	Description
S13096	AS50100003	PCD CUTTER.D.74X20X16+2KW R=1/1.5/2 Z=3+3+3 CCW.
S13097	AS50100004	PCD CUTTER D.74X20X16+2KW R=1/1.5/2 Z=3+3+3 CW.
S13498	AS50100012	PCD CUTTER D.74X20X16+2KW R=1/2/3 Z=3+3+3 CW.
S13499	AS50100013	PCD CUTTER D.74X20X16+2KW R=1/2/3 Z=3+3+3 CCW.
S13707	AS50100016	PCD CUTTER D.74X20X16+2KW R=1.5/2/3 Z=3+3+3 CCW.
S13708	AS50100015	PCD CUTTER D.74X20X16+2KW R=1.5/2/3 Z=3+3+3 CW.
S13887	AS50100019	PCD CUTTER D.70/64X35X16+2KW R=1.5 Z=6 CCW. (fixed radius)
S13888	AS50100018	PCD CUTTER D.70/64X35X16+2KW R=1.5 Z=6 CW.(fixed radius)
S13946	CSEN350157	PCD CUTTER D.70/64X35X16+2KW R=2.0 Z=6 CCW.(fixed radius)
S13947	CSEN350158	PCD CUTTER D.70/64X35X16+2KW R=2.0 Z=6 CW.(fixed radius)

**Edge Scraper
RBK - 503**

HM edge scraper insert

Characteristics:
For edge finishing

Design:
HM solid rounding insert

Materials:
Solid wood edges, supported
edges, plastic edges

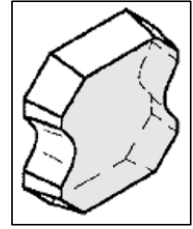

Wirutex Code	Biese Code	Description
D02329	N3402N0056	INSERT 12.7X12.7X3,18 R=1.0 SPEC.
D01536	N3402N0055	INSERT 12.7X12.7X3,18 R=1.5 SPEC.
D01535	N3402N0054	INSERT 12.7X12.7X3,18 R=2.0 SPEC.
D01553	N3402N0053	INSERT 12.7X12.7X3,18 R=3.0 SPEC.
D01548	N3402N0097	INSERT 12.7X12.7X3,18 25° SPEC.

**Edge Scraper
RB30 - RB40**

HM multi-profiled edge scraper insert

Characteristics:
For edge finishing

Design:
HM solid rounding insert

Materials:
Solid wood edges, supported
edges, plastic edges

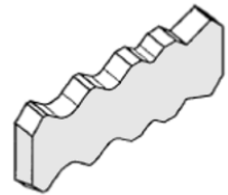

Wirutex Code	Biese Code	Description
D01534	N3402N0026	HM KNIFE 34X12,7X3 R=1,5/2/3
D01558	N3402N0077	HM KNIFE 34X12,7X3 R=1/2/3
D02524	N3402N0146	HM KNIFE 34X12,7X3 R=1/1,5/2

**Glue Scraper
RC10/SF**

HM Glue scraper insert

Characteristics:
To remove residual glue after edge
bonding process

Materials:
Solid wood edges, supported
edges, plastic edges

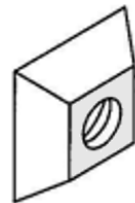
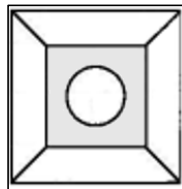

Wirutex Code	Biese Code	Description
D02489	N3402N0057	HM GLUE SCRAPER SOFT KNIFE 16X16X4,7

**Glue Scraper
RC05/SF**

HSS Glue scraper insert

Characteristics:
To remove residual glue after edge bonding process

Materials:
Solid wood edges, supported edges, plastic edges

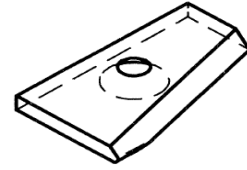
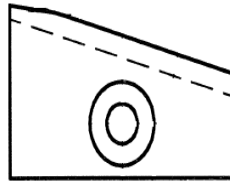

Wirutex Code	Biesse Code	Description
D01556	N3402N0075	HSS GLUE SCRAPER KNIFE 40X25X3 TOP LH
D01557	N3402N0076	HSS GLUE SCRAPER KNIFE 40X25X3 BOTTOM LH

**Glue Scraper
RC20**

HM Glue scraper insert

Characteristics:
To remove residual glue after edge bonding process

Design:
Triangular insert with 3 cutting edges

Materials:
Solid wood edges, supported edges, plastic edges

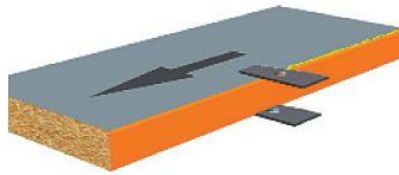

Wirutex Code	Biesse Code	Description
C00626	E3401E0117	TRIANGULAR INSERT 22,86X2,5 Z=3

**SOFT
SF10**

Cutter with PCD brazed-welded tips for IN-LAY workings

Characteristics:
For IN-LAY workings on SOFT-FORMING edge banding

Design:
Cutters with profiled PCD tips, brazed-welded by induction machine with optical/electronic control

RPM: 12.000/15.000
Materials: plastic edges

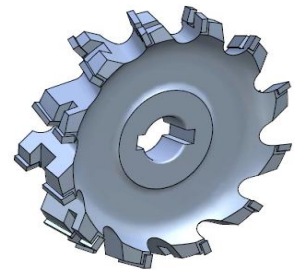
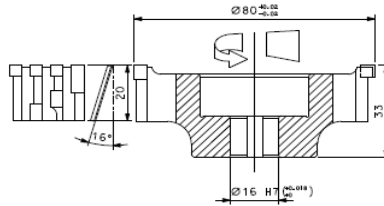

Wirutex Code	Biesse Code	Description
S07122	N3401N0421	PCD CUTTER D.80X20X16+2KW Z=8+2 CW. "IN LAY"
S07123	N3401N0422	PCD CUTTER D.80X20X16+2KW Z=8+2 CCW. "IN LAY"

**SOFT
RL10**

Glue scraper for IN-LAY workings

Characteristics:
To remove residual edge glue on IN-LAY working

Design:
HSS knife with 1 cutting edge

Materials:
Plastic edges

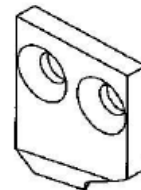
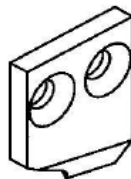

Wirutex Code	Biesse Code	Description
D02357	N3402N0037	HSS GLUE SCRAPER KNIFE UPPER LH LOWER RH
D02358	N3402N0038	HSS GLUE SCRAPER KNIFE LOWER LH UPPER RH